

DATE _____

3-PHASE INDUCTION MOTOR

FRAME NO. 250SC

P o l e	HP	kW	Hz	VOLT	r / m i n
4	75	55	—	—	—

Ins	Rating	Dimension in	Approx Weight	Bearings
F	CONT.	mm	609Kg	DE: 6317C3 NDE: 6313C3

Totally Enclosed Fan-Cooled Type, Squirrel-Cage Rotor.

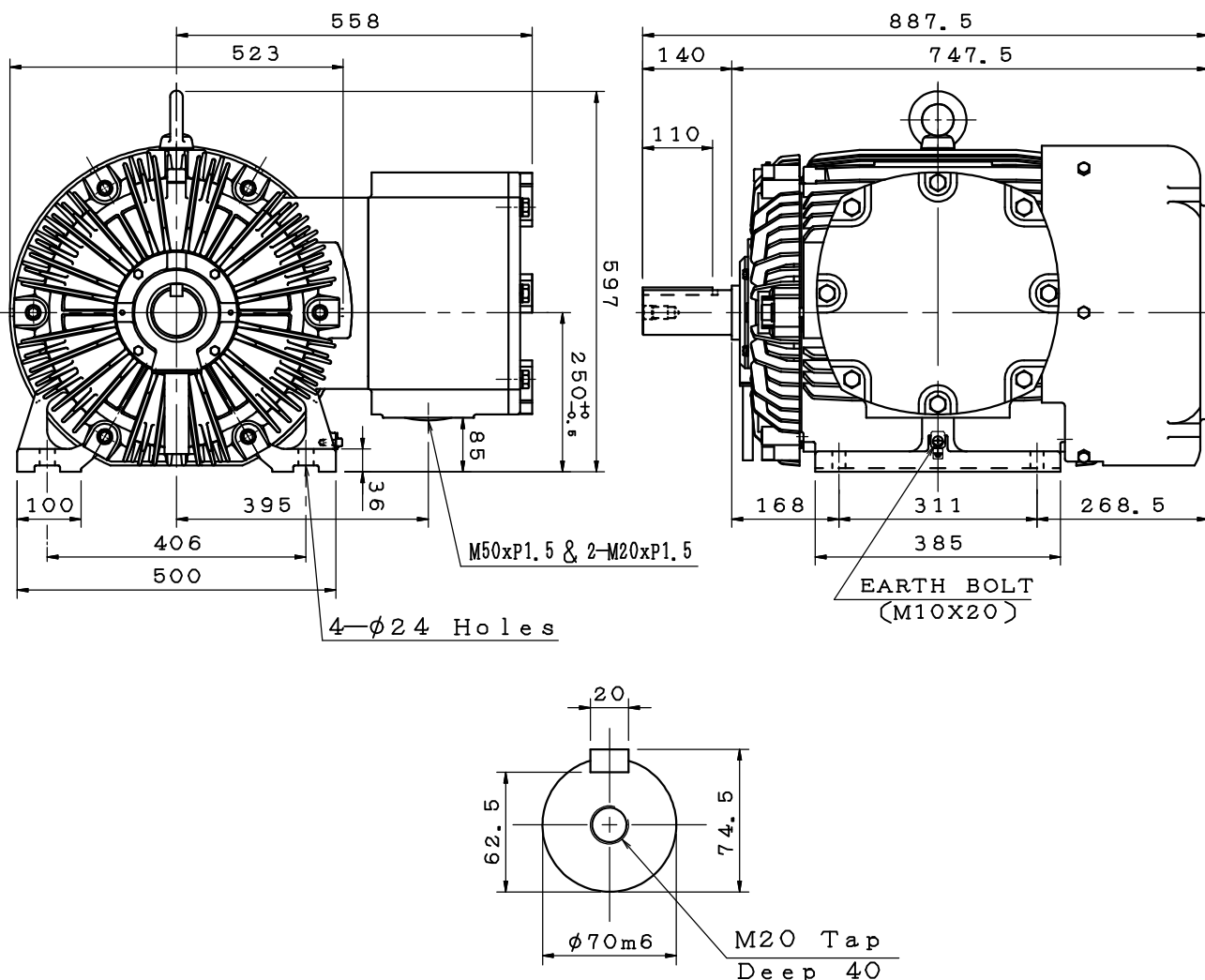

Note :

1. Ex db IIB T4 Gb & Ex db I Mb
(IECEX/ATEX).
2. IP56 Protection.
3. With Bearing RTD.
4. Fitted With SPM Adapter
(2-AT-103).

KS20044-1-00

0	.		.
---	---	--	---

DWG.	簡學民	08.06.20	東元電機股份有限公司 TECO Electric & Machinery Co., Ltd. TAIWAN	DWG NO.	31057M036770
CHKD.	簡學民	08.06.20			
APPD.	徐聰豪	08.06.20			