

# TECO

## OUTLINE DIMENSIONS

MOTOR TYPE:  
AEMBXZ-XXX

DATE

### 3-PHASE INDUCTION MOTOR

FRAME NO. 200LA

| Pole | HP     | kW           | Hz            | VOLT      | r/min      |
|------|--------|--------------|---------------|-----------|------------|
| 2    | 50     | 37           | —             | —         | —          |
| Ins  | Rating | Dimension in | Approx Weight | Bearings  |            |
| F    | CONT.  | mm           | 358 KG        | DE:6312C3 | NDE:6212C3 |

Totally Enclosed Fan-Cooled Type. Squirrel-cage Rotor.

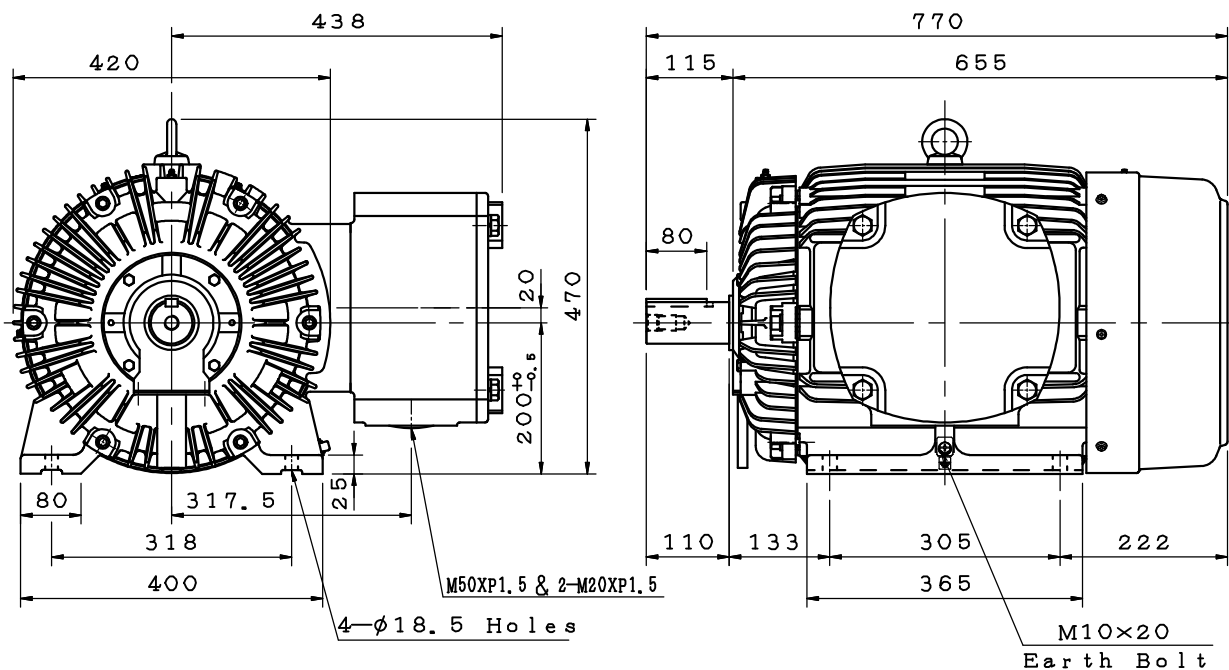

#### Note:

1. Ex db IIB T4 Gb & Ex db I Mb (IECEX/ATEX).
2. IP56 Protection.
3. With Bearing RTD.
4. Fitted With SPM Adapter (2-AT-103).

KS20044-1-00

|   |   |   |
|---|---|---|
| 0 | . | . |
|---|---|---|

|       |     |          |   |              |
|-------|-----|----------|---|--------------|
| DWG.  | 簡學民 | 08.06.20 | 東元電機股份有限公司<br>TECO Electric & Machinery Co., Ltd.<br>TAIWAN | DWG NO.      |
| CHKD. | 簡學民 | 08.06.20 |   | 31057M108230 |
| APPD. | 徐聰豪 | 08.06.20 |   |              |